

AGRICULTURAL MACHINERY  
**sitrex**®  
Spa

**ASSEMBLY  
AND  
SPARE PARTS LIST**

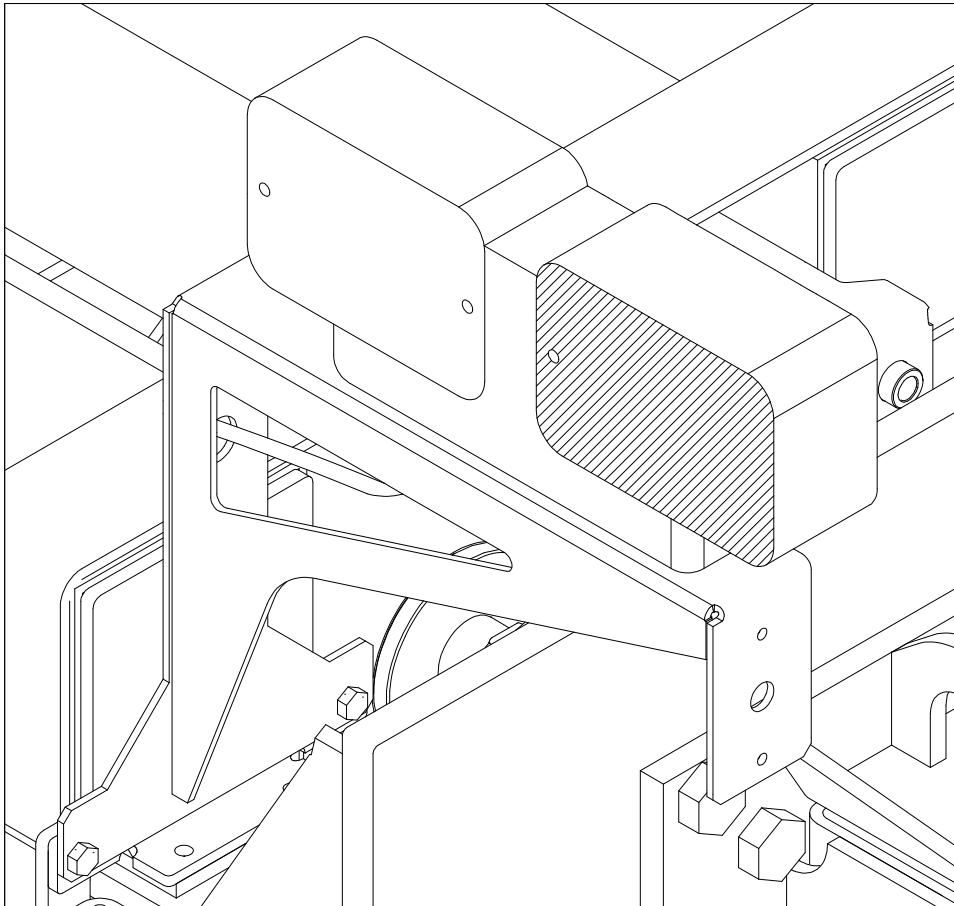

**LIGHTS KIT FOR *PRO/17***

**250.377**

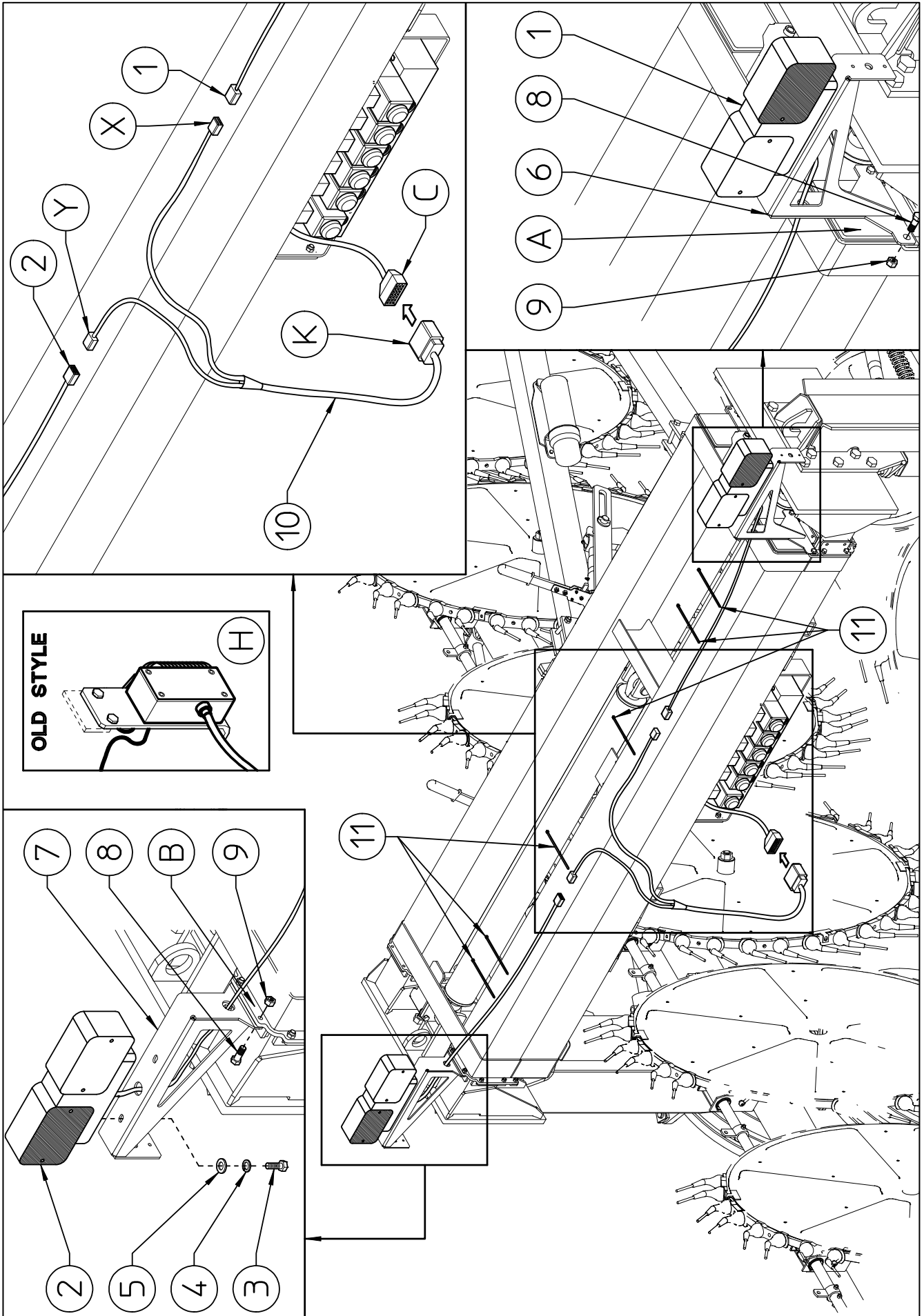

## **ASSEMBLY**

In order to assemble the lighting system on the machine, please follow the instructions described here below:

Assemble the lights supports 6 and 7 (RH-LH) on the machine at the points A and B, by first removing the pre-fitted screws (M8x25) and replacing them with the screws 8 (M8x30) and the nuts 9 (M8).

After having fixed the supports, you have to assemble the lights 1 and 2 (RH-LH), passing the electrical cables in the proper holes of the supports (7-8), and then fixing with the screws 3 (M8x16) and the washers 4 and 5.

Connect the cabling 10 to the lights 1 and 2 on the points X (RH) and Y (LH), then the plug K to the system C already present on the machine.

Using the clamps 11 secure the cables to the machine.

### **ATTENTION**

If the electrical system is an older model (H) is not present the plug C.

In this case the connection should be performed by a technician.

## **SPARE PARTS LIST**

<b>PART NO 250.377 LIGHTS KIT FOR PRO/17</b>				
<b>ITEM</b>	<b>Q.ty</b>	<b>SITREX PART NO</b>	<b>DESCRIPTION</b>	<b>NOTE</b>
1	1	250.274	LIGHT RH	
2	1	250.275	LIGHT LH	
3	4	600.061	SCREW M8x16 8.8 ZN DIN 933	
4	4	600.229	SPRING WASHER $\varnothing$ 8,4	
5	4	610.185	WASHER $\varnothing$ 9-24x2	
6	1	250.403	SUPPORT RH	
7	1	250.404	SUPPORT LH	
8	4	600.757	SCREW M8x30 8.8 ZN DIN 933	
9	4	600.076	NUT M8 DIN 980	
10	1	250.367	LIGHTS CABLES	
11	6	620.039	CLAMP 4,5x300	

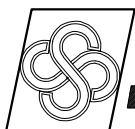

**AGRICULTURAL MACHINERY**  
**sitrex**® Spq .

Zona Industriale-Viale Grecia, 8  
06018 TRESTINA-(Perugia)-ITALY  
Tel. +39.075.8540021-Telefax +39.075.8540523  
e-mail: [sitrex@sitrex.it](mailto:sitrex@sitrex.it) [www.sitrex.com](http://www.sitrex.com)

